

Exhibit C

Fire Doors Inspection & Report

RFQ #22-1010

June 13, 2022



Agenda

- Introductions
- RFQ Schedule
- RFQ Requirements
- Floor Plans
- Scope of Work
- Sample Doors
- Questions

Introduction

- Robin Wied, Procurement Coordinator
- Shane Young, Procurement Manager
- Donald Bottger, Director Facility & Environmental Services
- Todd Temple, Director Public Safety & Guest Services
- Victoria Mitchell, Director Planning & Development

RFQ Schedule

Item	Date
Issue Date	June 6, 2022
Bidders Conference	June 13, 2022 (virtual)
Pre-Bid Question Deadline	June 16, 2022 at 5:00 PM PST
Bid Deadline	June 24, 2022 at 5:00 PM PST

All questions and submittals send via email to: robin.wied@visitsandiego.com

**SDCCC is not bound by oral interpretation of this RFQ unless subsequently issued in the form of a written Addendum.

RFQ Information

- Exhibits:
 - West Building Door Schedule
 - East Building Door Schedule
- Section 3 (Bid Form & Submittals)
 - All items must be completed to be considered for evaluation
 - Bid submittals:
 - Company Resumes
 - Sample Work Product
 - Proposed Work Plan

Floor Plans

- Interior Space: 1,763,876 Sq. Ft.
- **UPPER LEVEL**
 - 51 Meeting Rooms
 - 2 Ballrooms
 - Sails Pavilion
 - 2 Kitchens
 - Outdoor Terraces overlooking San Diego Bay
- **MEZZANINE LEVEL**
 - 12 Meeting Rooms
 - Outdoor Terraces overlooking San Diego Bay
 - Foyer Areas
- **GROUND LEVEL**
 - 525,701 gross sq. ft. of contiguous exhibit space
 - Lobby services and amenities
 - Pre-function space
- **PARKING**
 - 1,950-vehicle underground garage managed by ACE Parking

UPPER LEVEL

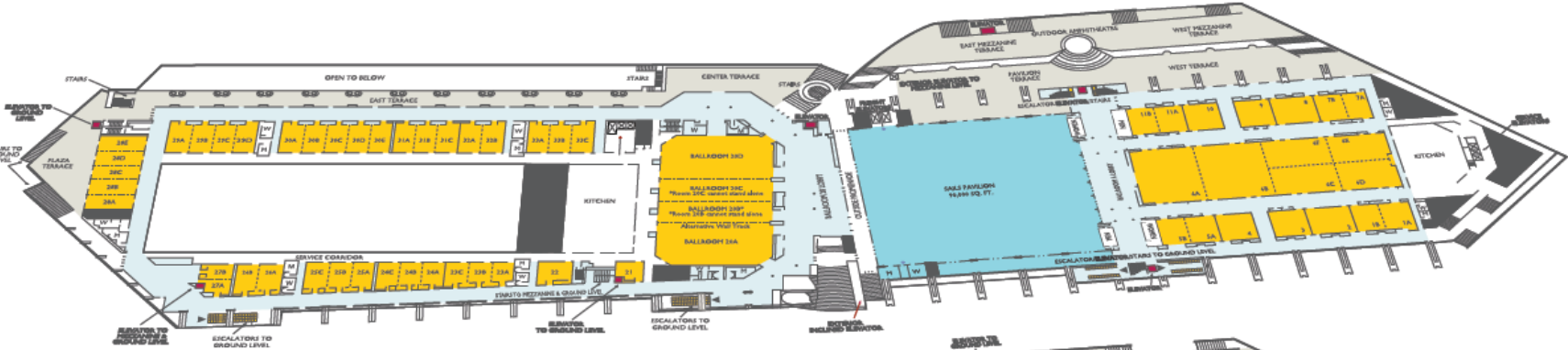

MEZZANINE LEVEL



GROUND LEVEL

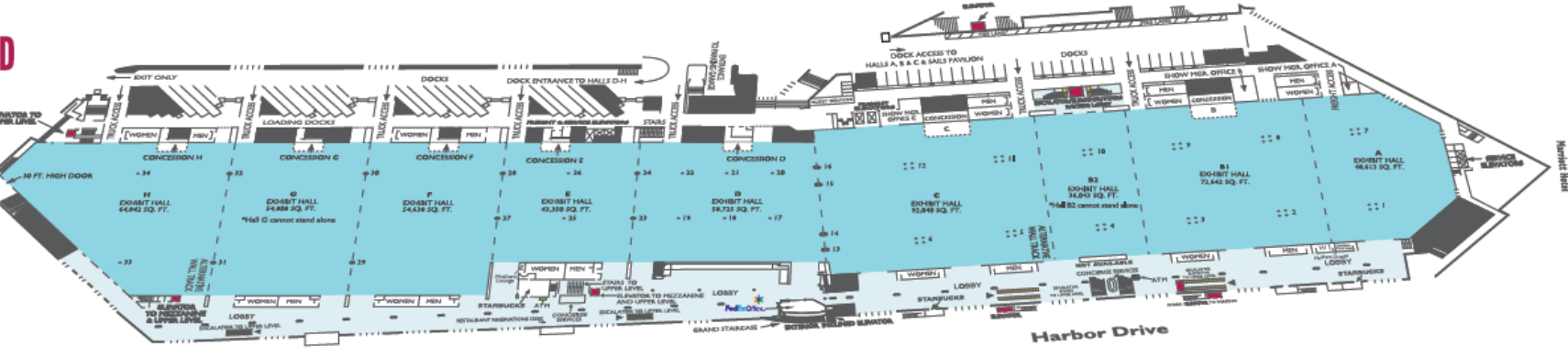

Scope of Work

- Overview:
 - Provide an assessment of the existing fire doors, frames, glazing, seals, and hardware at the San Diego Convention Center. This is to be accomplished by review of existing documentation, discussions with onsite personnel, and performing a walk-through of the building. Contractor shall develop recommendations and provide a written report detailing the findings. There is an expected quantity of 1,500 doors which can be used for bidding purposes. Actual number of doors may vary slightly.
- Standards:
 - NFPA: 80, 101, 105, 252
- Deliverables:
 - Written Report & Presentation
- Working Hours: 8:00 AM – 5:00 PM
- Schedule: 07/01/22 - 09/01/22

*Approximate door sizes below



83" x 36" Finance Area



112" x 37" Hall A Exit Door



113" x 48" UL Corridor Doors (West)



79" x 26" Women's Bathroom UL (West)



111" x 43" Exhibit Hall A Doors



84" x 48" Kitchen Doors (East)



109" x 47" Exit Door (East)



Questions

