



SAN DIEGO CONVENTION CENTER FACILITY GUIDE

BUILDING SERVICES & AMENITIES | MAPS & FLOOR PLANS



Contents

FACILITY OVERVIEW

Discover the Award-Winning San Diego Convention Center	3
Lobby & Prefunction Space	5
Exhibit Halls	5
Meeting Rooms.....	6
Ballrooms.....	6
Outdoor Space	7
Sails Pavilion.....	8
What Color is Your Meeting?	9
Space Details.....	10
Building Layout.....	10
Facility Features.....	11

SERVICES

Lobby Services & Amenities	12
Venue Services	13
Business Partners.....	14
Hybrid Events	16
Sustainability & Community	18

BUILDING MAPS

Building Overview	19
Floor Plans.....	20
Capacity Charts	25



Discover the Award-Winning San Diego Convention Center

We are proud to be the region's premier gathering place. Since opening our doors in 1989, our team's top priority has been to provide outstanding customer service so you'll want to come to San Diego over and over again.

LOCATION

The San Diego Convention Center is favorably located within walking distance of over 13,000 first-class hotel rooms and is just 10 minutes from the San Diego International Airport. Also within easy walking distance are hundreds of unique restaurants, shops, parks and attractions. Before or after meetings, attendees can stroll to the lively Gaslamp Quarter, Seaport Village, The Headquarters shopping district, the historic USS Midway Museum, and Petco Park, home to the San Diego Padres. Getting around the rest of town is simple with many convenient transit options.

SPACE

Our waterfront facility features 2.6 million gross sq. ft. with 615,701 sq. ft. of exhibit space and 204,114 sq. ft. of meeting space including two 40,000 sq. ft. ballrooms.

The Center is home to 284,494 sq. ft. of pre-function, lobby and registration space, as well as 184,514 sq. ft. of outdoor terrace space. Ultimate flexibility is offered for groups of any size. More than a half million sq. ft. of contiguous exhibit space is divisible into seven halls of varying sizes. Approximately fifty loading docks offer convenient access to exhibit halls.

FEATURES

The building's architectural centerpiece is a 90,000 sq. ft. Sails Pavilion that provides an open-air feel. The exhibit space allows meeting planners to customize lighting of the iconic Sails Pavilion roof. The glass-enclosed space features an industry standard trade show floor, high-tech lighting and a cooling and heating system for maximum comfort year-round. The column-free space is equipped for a variety of events, from trade shows and receptions to banquets and galas.

The Sails Pavilion is flanked by two ballroom foyers that provide excellent pre-function space for receptions, coffee breaks, and registration activities. The ballrooms themselves each offer more than 40,000 sq. ft. and can easily be divided into smaller sections, designed for maximum flexibility. Several meeting rooms open out to expansive terraces overlooking the San Diego Bay, the perfect place for attendees to soak up San Diego's year-round sunshine.

SERVICE

Renowned for our impeccable, high-quality service and experienced, award-winning staff, the Convention Center provides seamless customer service from the initial planning stages to the conclusion of an event. From housekeepers to groundskeepers to event managers, our Center's team has a special operating philosophy; each person who enters our doors becomes an honored guest. This can-do attitude ensures successful events and keeps meeting planners coming back to our center again and again.

HEALTH & SAFETY

The San Diego Convention Center's highly experienced staff will ensure appropriate health and safety protocols are in place to provide a clean and welcoming environment. We frequently communicate with meeting planners to provide up-to-date information about our protocols and applicable guidance from the CDC, State of California, and County of San Diego.

We're continually enhancing our facility and services. For the latest updates, see our website at visitsandiego.com.



Lobby & Prefunction Space

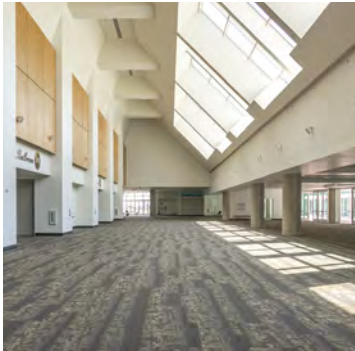

Enter the San Diego Convention Center and you're walking into an iconic architectural wonder. Translucent, barrel-vaulted glass skylights offer panoramic views of downtown San Diego. With 75,756 sq. ft. of space, and customizable digital signage, our lobby offers a bright and welcoming environment for your guests.

Exhibit Halls



The exhibit halls offer 525,701 sq. ft. of contiguous exhibit space on the ground floor. The main hall is divisible into seven halls, each of varying size. Streamlined columns provide column-free space in selected halls. Approximately 50 loading docks provide access.

Meeting Rooms



The building offers over 204,000 sq. ft. of meeting space in 72 meeting rooms located on the upper and mezzanine levels of the building.

Ballrooms



Two 40,000 sq. ft. ballrooms provide ample room for all your needs. The perfect combination of understated elegance and practical functionality, both ballrooms can accommodate larger general sessions or banquets, or can be divided into smaller rooms for any type of function.

Outdoor Space

With sunshine year-round, the terraces and outdoor mezzanine levels showcase San Diego's beautiful weather. Dramatic views of San Diego Bay and the Coronado Bridge make the terraces the perfect backdrop for any special event. The area features an observation deck and illuminated skywalk. With 184,514 sq. ft., there's ample room for both small and large functions.



Sails Pavilion

Considered the building's most iconic space, the Sails Pavilion offers 90,000 sq. ft. with sweeping views of the city and bay. Glass-enclosed with an industry standard tradeshow floor, the area is flexible for any type of event activity ranging from upscale receptions to exhibits. The newest enhancement and upgrade to the Sails Pavilion includes the option to customize LED colored lighting that is visible both inside and outside, illuminating the San Diego skyline.



What Color is Your Meeting?

Customize and personalize your event in a spectacular way through LED lighting in our iconic Sails Pavilion.

COMPLIMENTARY LIGHTING

Any client that has a full-facility contract can select one color of their choice to light up the Sails each evening of the contracted event days. This will be complimentary during any four-hour block of time of their choosing (ending at midnight) to showcase the color that best represents a specific event. This is our way of saying thank you for bringing your business to the San Diego Convention Center.

FIRST-COME, FIRST-SERVE LIGHTING

Any client that contracts a portion of space in the Center can receive one color for a single contracted event day of their choosing for four hours (ending at midnight). This will be on a first-come, first-serve basis if the Sails Pavilion has not been contracted.

CUSTOMIZATION

Customization includes:

- Consultation and informational meeting on LED capabilities
- Custom light show design and test
- Pre-Show video presentation and final customization
- Showtime remote monitoring for a seamless lighting show rollout

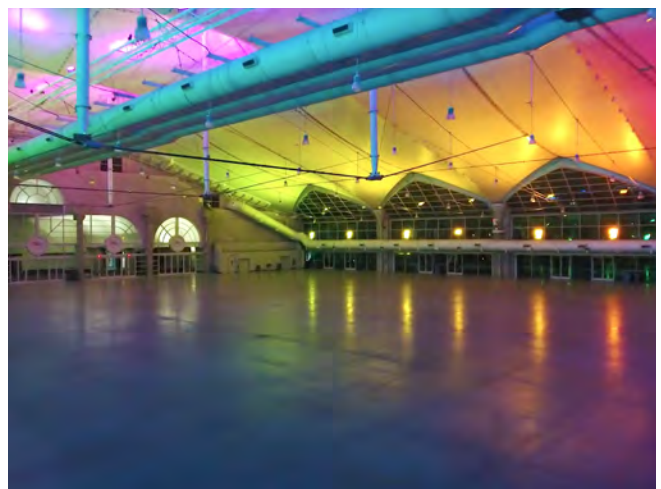
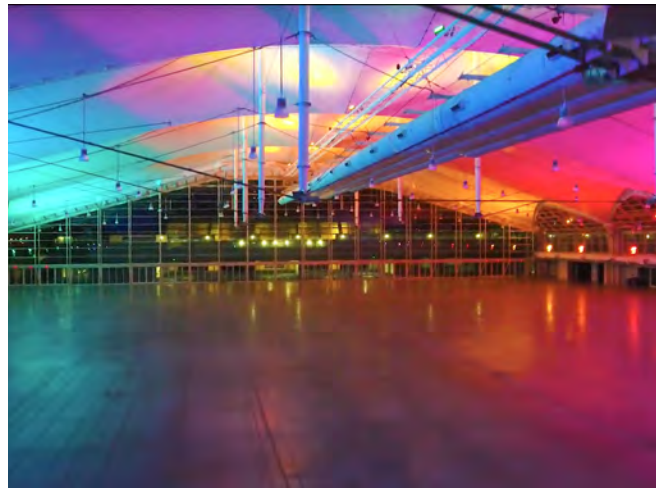

Space Details

GRAND LOBBY/PREFUNCTION

- 284,494 sq. ft.
- 10 escalators and 3 passenger elevators
- Starbucks Cafes in Lobbies A, C and E
- FedEx Business Office in Lobby D
- ATM Machines in Lobbies B and E
- Mothers' Lounges in Lobbies A and E
- Inclusive Restroom in Lobby A

EXHIBIT HALLS

- 525,701 sq. ft.
- Contiguous space can be divided into 7 halls (Halls B2 & G cannot stand alone)
- Ceiling height in Halls A-E is 27'4"
- Ceiling height in Halls F-H is 36'4"
- Floor load capacity is 350 lbs. per sq. ft.
- Exhibit halls include standard trade show floor with utility boxes on 30 ft. centers
 - Halls A-C floor boxes (electrical, telecom, water, drain and air) on grid format in varied combinations
 - Halls D-H floor boxes (electrical, telecom and drain) on grid format in varied combinations. Some air and water from supported catwalks above
- Clearances
 - Halls A, B, and C:
27 ft. to bottom of truss, 40 ft. to ceiling
 - Halls D and E:
27 ft. to bottom of truss, 39 ft. to ceiling
 - Halls F, G, and H:
36 ft. to bottom of truss, 64 ft. to ceiling

BALLROOMS/MEETING ROOMS

- 204,114 sq. ft.
- Up to 72 meeting/multi-purpose rooms with airwalls, including 2 Ballrooms
- Mezzanine level rooms feature windows and glass doors leading out to Mezzanine Terraces with bay views
- Room 28 features glass doors leading out to the Plaza Terrace and cityscape views

OUTDOOR TERRACES

- 184,514 sq. ft.
- 7 outdoor terraces with views of San Diego Bay and Coronado
- Plaza Park, a two-acre park designed as a special events venue
- Planters and foliage throughout the outdoor spaces
- Access to power and specialty lighting

SAILS PAVILION

- 90,000 sq. ft.
- Located directly between two 40,000 sq. ft. ballrooms
- Glass-enclosed walls provide open-air feel and spectacular views
- Utility boxes on 30" centers
- Access to 2 freight elevators
- Floor load limit is 150 lbs. per sq. ft.
- 27 ft. clearance to lighting encasement
- New concrete floor and refurbished iconic Sails Pavilion roof featuring LED lights

Building Layout

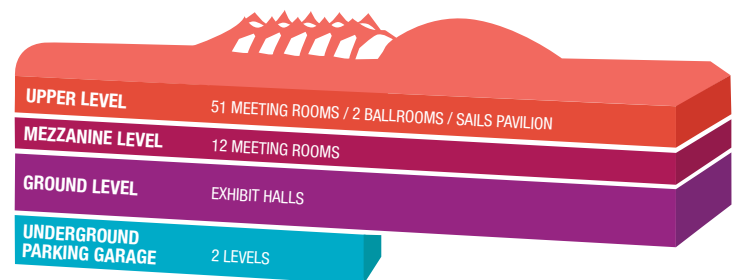

UPPER LEVEL

- 51 Meeting Rooms
- 2 Ballrooms
- Sails Pavilion
- 2 Kitchens
- Outdoor Terraces overlooking San Diego Bay

MEZZANINE LEVEL

- 12 Meeting Rooms
- Outdoor Terraces overlooking San Diego Bay
- Foyer Areas

GROUND LEVEL

- 525,701 gross sq. ft. of contiguous exhibit space
- Lobby services and amenities
- Prefunction space

PARKING

- 1,950-vehicle underground garage managed by ACE Parking

Facility Features



TECHNOLOGY

- High density full facility Wi-Fi 802.11 a/g/n/ac
- 5 Ghz in exhibit halls
- Complimentary 2.4Ghz and 5 Ghz Wi-Fi in lobby and common spaces
- Complete telephone service
- Cable Television Service
- Multi-cellular carrier distributed antenna system (DAS)
- High speed wired Internet and other special data circuits
- Temporary LAN/WAN/VPN networks
- Point-to-point networking
- EventPath™ Fiber connectivity to surrounding hotels
- In-house digital two-way radio system
- Redundant 10 Gbps circuits and optical fiber backbone
- Onsite staff and 24/7 remote support for monitoring, network design and data engineering services

DIGITAL SIGNAGE

- Digital signage is offered to customers in key locations, along with mobile displays

FOOD AND BEVERAGE SERVICES

- 7 concession stands in exhibit halls
- 2 full-service kitchens
- Portable specialty services
- Fish Taco Cart (set in your chosen location)

AUDIO VISUAL

- Complete audio visual design and production capabilities

BUSINESS SERVICES

- Full-service business center providing fax, copying, express mail, packaging and printing

ELEVATORS AND ESCALATORS

- 8 passenger elevators
- 3 freight elevators with a 20,000-lb. capacity
- 2 freight/service elevators with 10,000-lb. capacity
- 3 service elevators with 5,000-lb. capacity
- 14 escalators

ELECTRICAL

- 120, 208, 227, and 480 V (single and three phase)
- Full range of electrical services are available through your approved electrical provider

PARKING

- Underground parking structure offers 1,950 spaces and adjacent parking structure offers 2,000 spaces
- Entrances off Harbor Drive
- No overnight parking

LOADING DOCKS

- Approximately 50 loading docks
- 30 ft. high elephant door located at Hall H

ACCESSIBILITY

- The San Diego Convention Center is in compliance with the Americans with Disabilities Act

Lobby Services & Amenities

With everything from charging stations to coffee shops, many of our guests' needs will be met without having to leave the building. We take care of all the details so you can focus on the bigger picture.



STARBUCKS

Get fueled up on coffee! Choose from three locations in **Lobbies A, C and E.**



FEDEX OFFICE BUSINESS CENTER

Do all your shipping, mailing, printing and other business needs at our on-site business center located in **Lobby D.**



MOTHERS LOUNGE

We are proud to offer two mothers lounges, located in **Lobbies A & E.**



INCLUSIVE RESTROOM

An inclusive restroom with two private single-occupancy rooms, each with a locking door and floor-to-ceiling walls is located in **Lobby A.**



WATER FILL STATIONS

Refill your reusable bottle at stations throughout the building.



GUEST SERVICES

Have questions? Need directions? Our friendly team of **uniformed guest services professionals** can help you find your way.



FREE WI-FI

Available in **all lobbies.**



CHARGING STATIONS

Take a quick break to charge your devices at one of our stations, located along the **lower level lobbies.**

Venue Services

Hosting the best events takes the best facility paired with the best services.

GUEST SERVICES

As the first convention center in the nation to have uniformed door greeters welcoming our guests, our friendly guest services team is always ready to help attendees get where they're going. They are the best in the business at assisting with special needs and are experts in providing directions and managing traffic flow.

HOUSEKEEPING & CLEANING SERVICES

Professional, efficient, and friendly, our cleaning staff takes great pride in maintaining an immaculate facility from top to bottom. We use cleaning products that are environmentally-friendly and our housekeeping staff is at the heart of our award-winning recycling program. Cleaning services are exclusively provided by the San Diego Convention Center.

SECURITY

Our building places a high priority on safety and security for our attendees. Ensuring a smooth operation, our security team is extensively trained and responsible for all public areas including facilitating dock operations and directing shuttle and vehicle traffic on the front drive. For leased space, we have a list of approved event security providers, all professionals in the field of conventions, trade shows, and public events.

LABOR PARTNERS

The San Diego Convention Center has a long and productive relationship with our labor partners. Our award-winning customer services are directly attributed to our staff, as well as our strong partnership

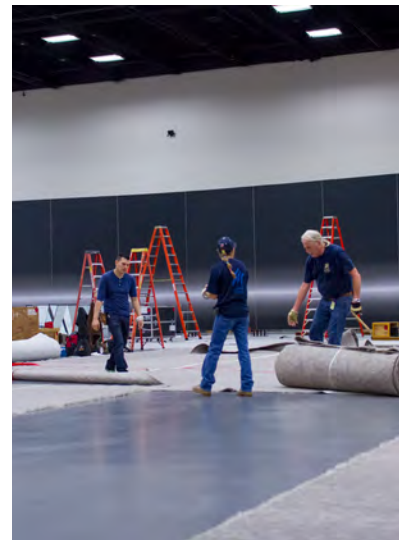
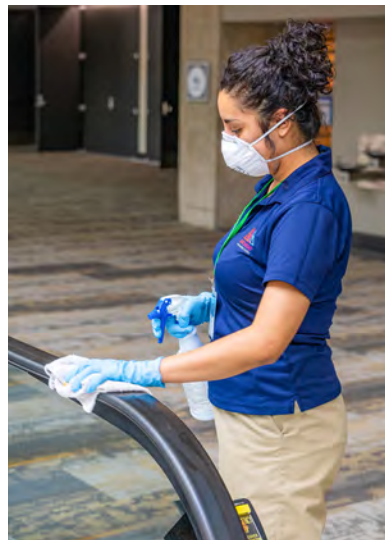

with local unions. To ensure exceptional customer service and quality workmanship, SDCC maintains formal agreements with eight local labor unions. The result has been a working environment in which both the Center and labor are committed to maintaining the highest level of customer satisfaction. It has also ensured that work is performed at a reasonable cost that reflects the highest level of efficiency, productivity, and quality. For details, please refer to our Regulations at visitsandiego.com.

Business Partners

We've got all of your needs covered under one roof.

FOOD AND BEVERAGE

From first course to last, our exclusive onsite food and beverage provider, *Sodexo Live!*, has pleased plenty of discerning palates with its mouth-watering cuisine. *Sodexo Live!* offers impeccable service and a superb selection of menus for every occasion and size. Each guest is treated to a unique culinary experience from our team of talented professionals.

Contact

Phone: 619.525.5800 | Fax: 619.525.5858

Web: visitsandiego.com/meeting-planners/food-beverage

Email: catering@visitsandiego.com

TECHNOLOGY

Smart City Networks, the Convention Center's exclusive technology services provider, offers network solutions designed specifically for the convention, trade show and meeting environment. Their networks link attendees, exhibitors and meeting planners through telephone, high-speed Internet, digital radio, and redundant 10 Gigabit circuit backbone. A dedicated staff of customer care professionals is onsite along with 24/7 network monitoring and remote staff support committed to the success of each event.

Contact

Phone: 619.525.5500 | Fax: 619.525.5502

Web: visitsandiego.com/meeting-planners/technology

Email: sdcccsr@smartcity.com

AUDIO VISUAL

ON Site is our preferred provider of audio visual services and the exclusive provider



of production rigging and in-house sound. ON Site provides custom solutions to meet hybrid event needs, supporting a stellar experience for virtual and in-person attendees alike.

Boasting one of the largest rental inventories of cutting-edge technology, ON Site has both the equipment and the expertise to translate your vision into reality. With over 30 years of experience, ON Site can service all of your meeting needs from the exhibit hall to the ballroom and everything in between.

Contact

Phone: 619.525.5444 | Fax: 619.525.5338

Web: visitsandiego.com/meeting-planners/audio-visual

Email: onsite-sdcc@onservices.com

FEDEX

FedEx Office, our onsite printing and shipping center, makes it easy for you, exhibitors, and attendees to get every business and document need taken care of in one convenient stop. They offer full-service black and white and color digital printing as well as finishing services including laminating, collating, stapling and binding. Signs, banners, copies and graphics can be ordered from your home base and printed here at the Convention Center, saving you time, shipping and money.

Contact

Phone: 619.525.5450

Web: visitsandiego.com/meeting-planners/fedex

Email: usa1324@fedex.com

DIGITAL SIGNAGE

Digital Conventions, our digital signage partner, is ready to help you enhance the experience of your event. High-definition digital signage can deliver real-time information to your attendees, integrate with your social media and stream live event content to video screens throughout our venue. This modern approach is perfect for wayfinding, advertising, announcements and more.

Contact

Phone: 877.359.3400

Web: visitsandiego.com/meeting-planners/digital-signage

Email: ccrawford@digitalconventions.com

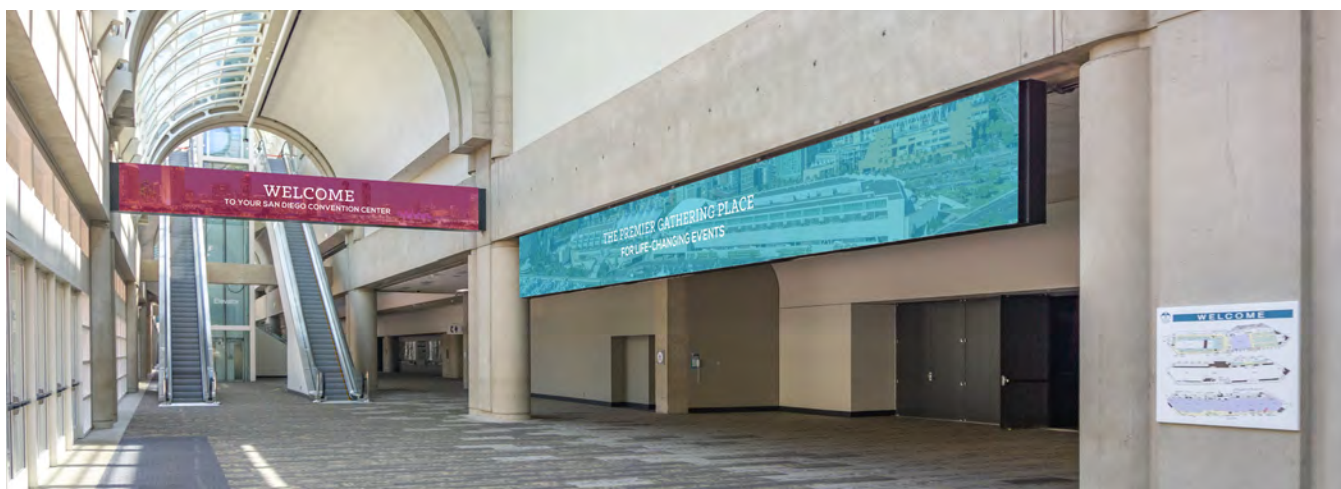



Hybrid Events

The San Diego Convention Center is prepared to help you offer successful events that feature in-person programming and virtual components, often referred to as hybrid events. The information below details the scale and capabilities we have in our facility.

PARTNERS

With our infrastructure and our experienced in-house technology partners ON Site and Smart City, we can help you simplify the process of producing hybrid events. The ON Site team provides equipment, platform, labor, content creation, program and technical direction and more. Smart City will ensure you have the necessary connections, secure access and dedicated bandwidth for virtual components.

SERVICES

Hybrid event activity may scale from a video call in small meetings to live-streaming sessions for remote viewers to presenting keynotes with multiple live speakers in remote locations interacting with in-person attendees. The following menu includes our most popular offerings; our team is able to customize our services to meet your specific event needs.

TECHNICAL SUPPORT

Providing technical and consulting support for customers bringing their own software and equipment.

BASIC VIDEO CALLS

Usually a single speaker on a video call using existing meeting equipment (computer, projector, screen, microphones, camera, lighting) and a platform provided by either the client or ON Site.

ENHANCED VIDEO CONFERENCES

Offering a more complex video conference using Zoom, Teams or an equivalent video conferencing platform to better facilitate multiple remote participants. Potentially use split screens or multiple screens to simultaneously show a presentation and speakers.

PRODUCTION AND TECHNICAL DIRECTION

Collaborating with you to produce the hybrid programming. This production can involve script-writing, set design, live camera-switching, cueing speakers and routing video feeds.

RELIABLE & DEDICATED BANDWIDTH

Strong internet connections to meet event needs for video streaming and interactivity. Smart City contracts with at least two carriers with separate points of entry into the facility for bandwidth. Should one circuit fail, we have automatic failover to the back-up circuit so there is no downtime to clients.

INTERACTIVE CHAT AND POLLING

Creating virtual lounges where remote viewers can interact with either an in-person or remote speaker. Chat text may appear on screen for the speaker and/or the in-person audience. Polling tools allow for seamless collective interaction between the audience and speaker.



COMPLETE HYBRID CONFERENCE PLATFORM

For a fully immersive and cohesive hybrid conference experience, a single platform can be used for broadcast management, virtual lounges, speaker-ready rooms, and audience interactions.

PRE-EVENT RECORDINGS

Producing video recordings either in advance of an event or before a scheduled release time. Videos may be published on your website or made available to attendees through other methods.

OFF-SITE BROADCAST STUDIO LOCATION

Providing an off-site studio, potentially in a different city, for remote speakers to conduct high-quality live-streaming.

CONTENT CREATION AND MUSIC LICENSING

Assisting with licensing music or other content that you may want to include in your virtual materials. Content creation may include full titles and graphics, custom animations and show theme design.

SOCIAL DISTANCING SOLUTIONS

Facilitating presentation overview rooms and lounges, touchless registration stations, social distance measurement systems, and virtual information booths.

MAXIMIZING SPONSORSHIP OPPORTUNITIES

Supporting you with identifying unique opportunities, maximizing exposure for sponsors during hybrid events and tracking analytics.

24/7 MONITORING & SUPPORT

A local team is available during event hours and on-call 24/7. All ports are polled every 3 to 5 minutes for connectivity and network stability. Additional network switches and wireless access points are kept on-hand and connected to networks at all times.

We can customize our solutions to meet your vision and needs. Contact your event manager to get started today!

Sustainability & Community

The San Diego Convention Center has been a proud industry leader in sustainability for decades. In 2018, we achieved Level Three certification to the APEX/ASTM Environmentally Sustainable Event Standards.

We also support our community through donation drives and volunteer activities in partnership with local nonprofits serving the military, children, and unsheltered populations.



sustainability

ENVIRONMENTALLY CONSCIOUS

We believe in the importance of recycling and reducing waste. 4-Stream waste receptacles are located throughout the building, allowing attendees to recycle during events. The four streams include paper, recyclables, trash and compost.

Additionally, we are environmentally-responsible with the products we purchase, including paper towels, tissues, toilet paper, cleaning products, cutlery, plates, and more. When we need to use single-use containers, products made from renewable sources are our standard. All of our in-house contractors are required to adhere to the same purchasing practices.

EFFICIENT AND SUSTAINABLE ENERGY USE

In 2021, we began partnering with San Diego Community Power to source sustainable energy from renewable energy sources, which increased our renewable percentage from 31% to 50%.

When maintaining and updating our building, we seek to incorporate green solutions. For example, our entire facility uses LED light fixtures, including the lights in our iconic Sails Pavilion.

ECO-FRIENDLY COMMUTING

Together with regional transportation organizations, we promote use of public transit. Our building is across the street from a trolley stop and less than a mile from a train station that connects employees and visitors to North San Diego, Los Angeles, and beyond.



COMPOSTING

We compost all non-edible food. Our kitchens do not have garbage disposals so no food scraps are wasted. We have composted as much as 180 tons of non-edible food in a single year.

DONATIONS

When food is prepared but not served, we donate it to the San Diego Rescue Mission. One year's worth of food donations plates over 100,000 meals, on average.

Another big part of our donation program is providing convention items that can be used by local organizations. One example is partnering with Habitat for Humanity to provide materials they can use to build houses. With effective coordination, our team can ensure that meeting planners and exhibitors are able to donate excess items and materials.

Building Overview

Wayfinding is made easy with our building map. Go to visitsandiego.com/building-map to view it online.

UPPER LEVEL

Meeting Rooms 1–11, Ballroom 6, Sails Pavilion
Ballroom 20, Meeting Rooms 21–33

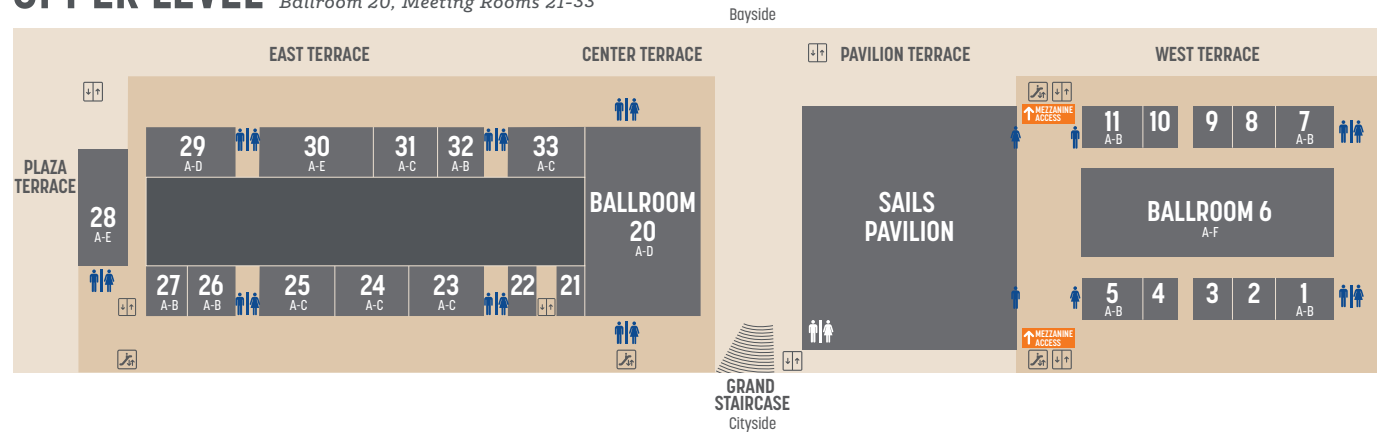

MEZZANINE LEVEL

Meeting Rooms 12–19

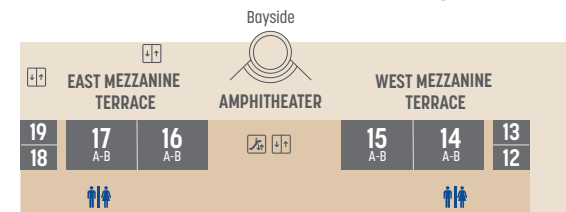

GROUND LEVEL

Lobbies A–H, Exhibit Halls A–H, Plaza Park

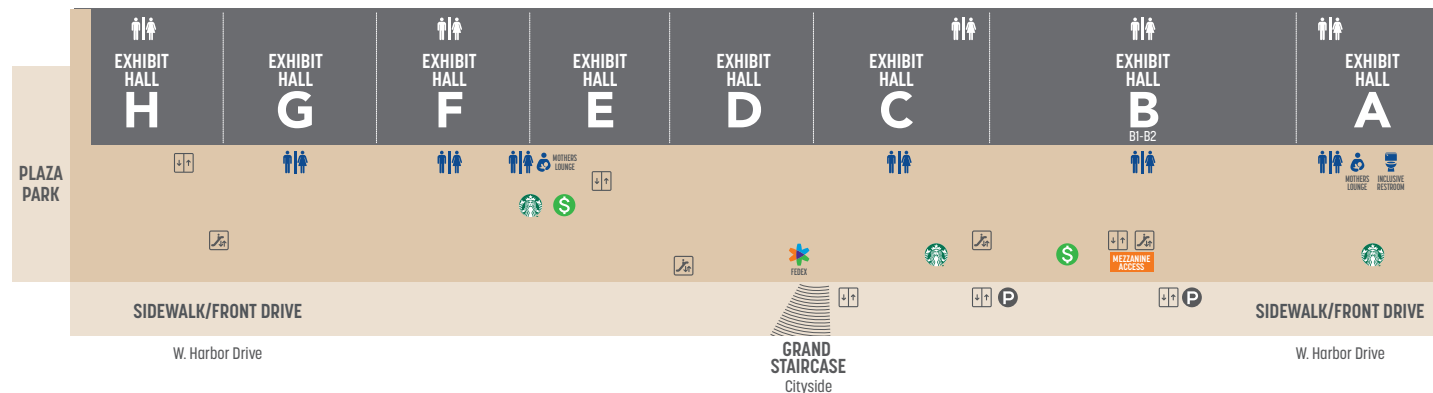

Floor Plans

Iron out the fine details of your event with our planning resources, at visitsandiego.com/meeting-planners/planning-resources.

FLOOR PLAN OVERVIEW

UPPER LEVEL

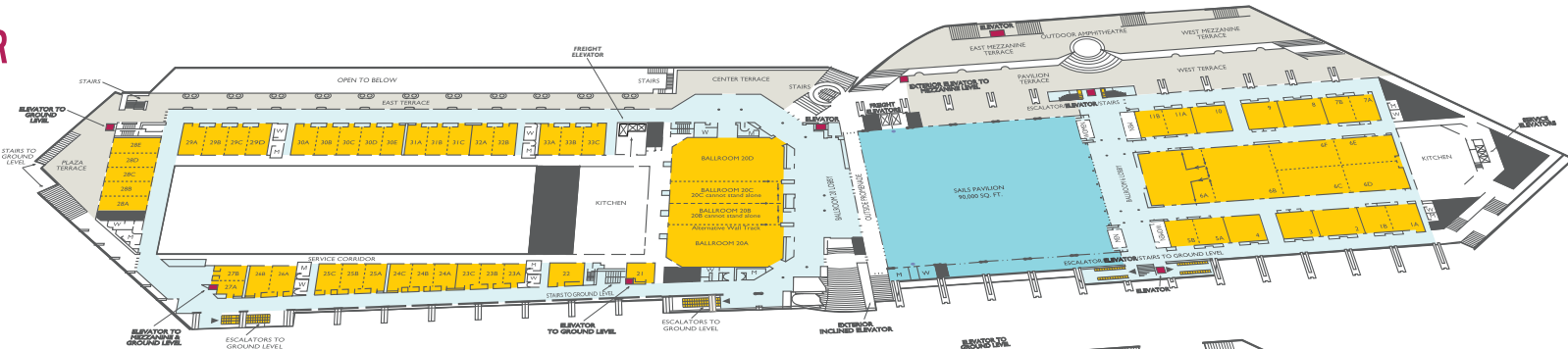

MEZZANINE LEVEL

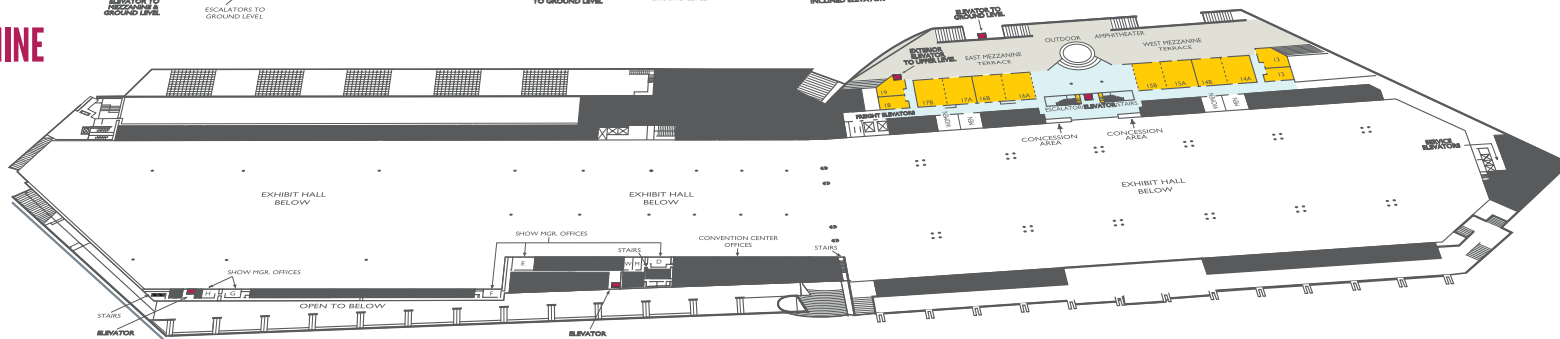

GROUND LEVEL

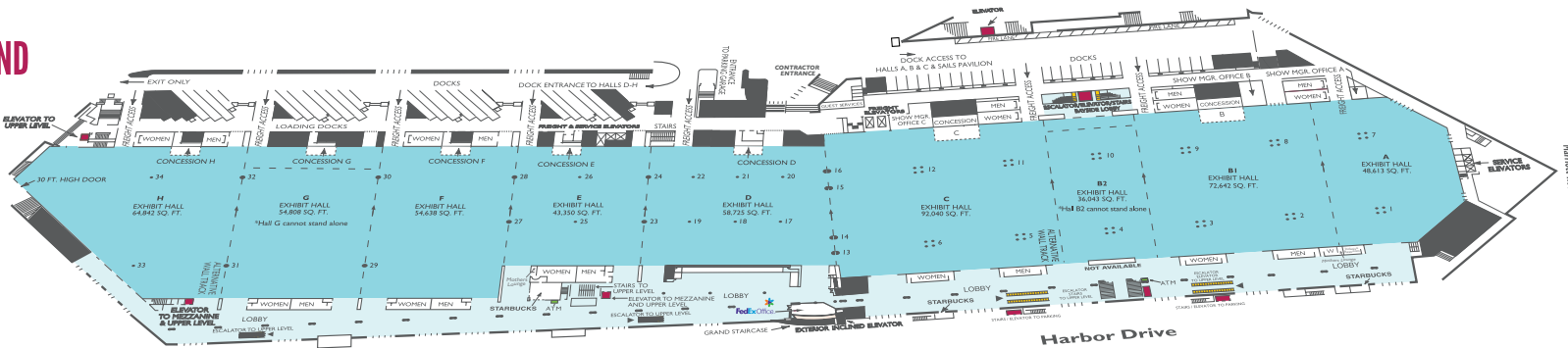

GROUND LEVEL VIEW

- B2 DOES NOT STAND ALONE
- G DOES NOT STAND ALONE
- 50 LOADING DOCKS

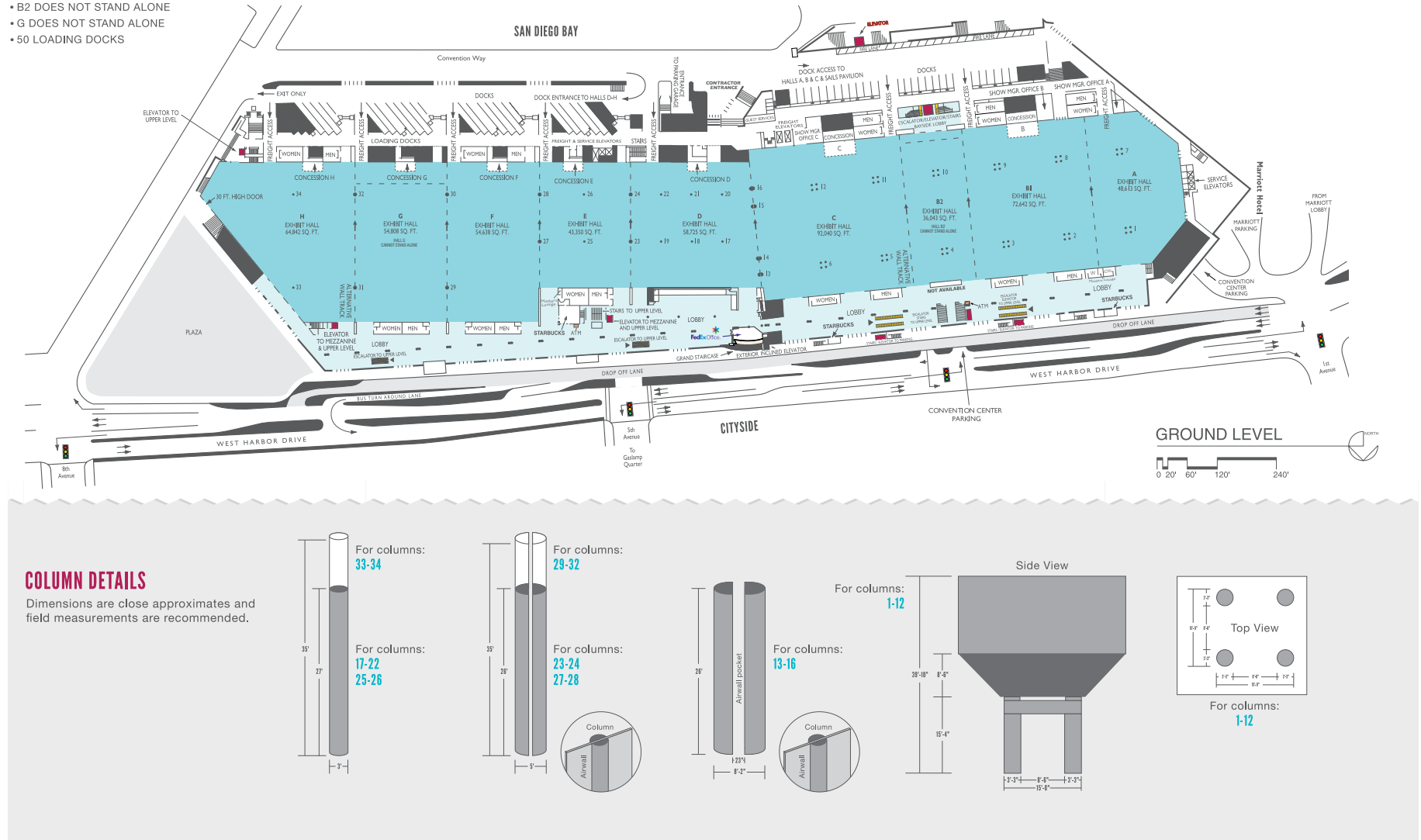



MEZZANINE LEVEL VIEW

- ACCESS TO MEZZANINE THROUGH:
 - BACK OF HALLS B & C
 - 6A FOYER





Capacity Charts

GROUND LEVEL SPECIFICATIONS

ROOM NAME	DIMENSIONS	SQUARE FEET	CEILING HEIGHT	10' X 10' BOOTHS	SEATING CAPACITIES			
					THEATER	CLASSROOM	BANQUET	RECEPTION
Exhibit Hall ABCDEFGH	1918'0" x 304'0"	525,701	varies	2939	**	**	**	**
• Exhibit Hall ABC	838'9" x 299'4"	249,338	27'4" 40'0"	1388	20,000	16,936	12,640	20,000
• Exhibit Hall A	180'0" x 299'4"	48,613	27'4" 40'0"	270	4,500	2,850	2,140	4,500
• Exhibit Hall B1	236'9" x 299'4"	72,642	27'4" 40'0"	406	6,000	4,548	3,120	6,000
• Exhibit Hall B2*	119'9" x 299'4"	36,043	27'4" 40'0"	203	2,500	1,808	1,390	2,500
• Exhibit Hall B1/B2	299'4" x 356'6"	108,685	27'4" 40'0"	609	8,500	6,772	5,060	8,500
• Exhibit Hall B2/C	299'4" x 418'3"	128,083	27'4" 40'0"	708	9,100	7,288	5,880	9,100
• Exhibit Hall C	298'6" x 299'4"	92,040	27'4" 40'0"	509	6,600	5,300	4,600	6,600
• Exhibit Hall DEFGH	1072'6" x 304'0"	276,363	varies	1551	**	**	12,770	**
• Exhibit Hall D	256'0" x 240'4"	58,725	27'4" 39'0"	324	5,880	4,244	2,690	5,880
• Exhibit Hall E	180'0" x 240'4"	43,350	27'4" 39'0"	240	4,330	3,044	2,010	4,330
• Exhibit Hall F	180'0" x 304'0"	54,638	36'4" 64'0"	311	5,750	3,840	2,480	6,000
• Exhibit Hall G*	180'0" x 304'0"	54,808	36'4" 64'0"	311	5,750	3,840	2,480	6,000
• Exhibit Hall H	295'0" x 304'0"	64,842	36'4" 64'0"	365	6,130	4,520	2,900	6,700
• Exhibit Hall FG	360'0" x 304'0"	109,446	36'4" 64'0"	596	12,000	8,536	5,690	12,000
• Exhibit Hall GH	475'0" x 304'0"	119,650	36'4" 64'0"	604	12,327	9,568	6,150	12,700
Show Office A	30' x 20'	600 gsf						
Show Office B	30' x 30'	900 gsf						
Show Office C	11' x 23'	450 gsf						
Show Office D	32' x 23'8"	700 gsf						
Show Office E	28' x 23'8"	650 gsf						
Show Office F	24'4" x 15'10"	350 gsf						
Show Office G	24' x 15'10"	330 gsf						
Show Office H	24' x 15'10"	330 gsf						
DOOR DIMENSIONS								
Front Entrance Doors	7'w x 9'h							
Exhibit Hall Doors	6'w x 9'h							
Freight Door (A)	20'w x 16'h							
Freight Door (B)	20'w x 16'h							
Freight Door (C)	20'w x 16'h							
Freight Door (D)	23'w x 16'h							
Freight Door (E)	23'w x 16'h							
Freight Door (F)	23'w x 16'h							
Freight Door (G)	23'w x 16'h							
Freight Door (H)	23'w x 16'h							
Elephant Door (H)	23'w x 30'h							
CONCESSION AREAS								
(A)	N/A							
(B)	45' x 25'							
(C)	45' x 25'							
(D)	30' x 30'							
(E)	30' x 30'							
(F)	30' x 30'							
(G)	30' x 30'							
(H)	30' x 30'							

General Information

Capacities	All capacities based on calculations of the San Diego Fire Marshal
Floor Loads	350 lbs. per sq. ft.
Airwalls	Sound absorptive panels; denoted by dotted lines
Columns	Four column types as denoted on diagram by numbers
Utility Boxes	Floor utility boxes are on 30 ft. centers; all boxes have phone and electrical (110 v. on 30 amp. breakers, single phase, and 208 v. on 60 amp breakers, single phase)
Lighting	LED lighting <i>Note: color temperature of LED lighting is 5K</i>

* Halls B-2 and G do not stand alone.

** Capacities vary. Contact your San Diego Convention Center event manager for custom room set ups.

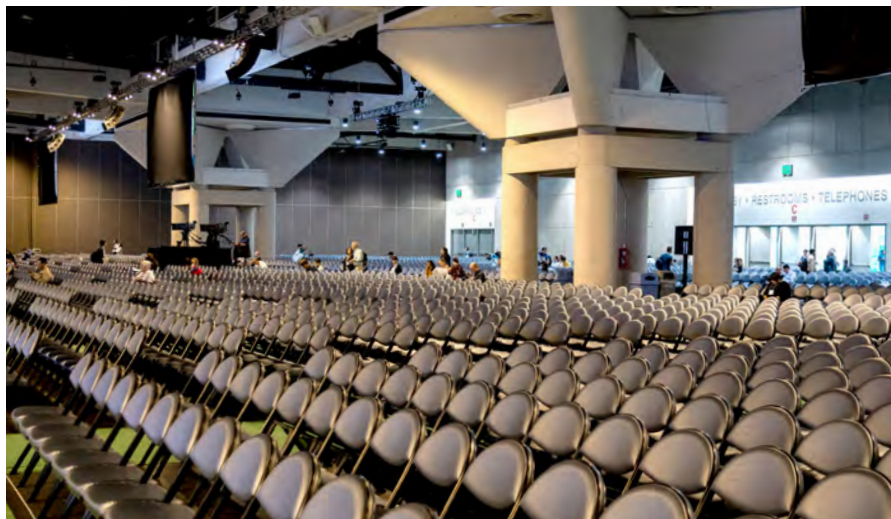

MEZZANINE LEVEL SPECIFICATIONS

ROOM	DIMENSIONS	SQUARE FEET	CEILING HEIGHT	SEATING CAPACITIES			
				THEATER	CLASSROOM	BANQUET	RECEPTION
12	27'10" x 38'11"	1,055	10'	84	55	40	150
13	34'1" x 36'10"	1,038	9'11.5"	75	60	40	152
14AB	77'1" x 58'5"	4,616	14'6"	520	296	180	665
• 14A	37'7" x 58'5"	2,310	14'6"	230	117	90	332
• 14B	39'6" x 58'6"	2,306	14'6"	230	130	90	334
15AB	79'2" x 58'6"	4,615	14'6"	546	296	180	665
• 15A	39'6" x 58'6"	2,304	14'6"	235	130	90	334
• 15B	39'8" x 58'6"	2,311	14'6"	230	130	90	332
16AB	79'3" x 58'7"	4,626	14'6"	546	296	180	665
• 16A	39'8" x 58'7"	2,312	14'6"	230	130	90	332
• 16B	39'7" x 58'7"	2,314	14'6"	230	130	90	334
17AB	79'2" x 58'6"	4,615	14'6"	546	296	180	664
• 17A	58'6" x 39'7"	2,311	14'6"	230	130	90	332
• 17B	58'6" x 39'7"	2,314	14'6"	230	130	90	332
18	27'8" x 38'11"	1,049	9'11.5"	84	55	40	150
19	34'8" x 36'8"	1,007	9'11.5"	72	51	40	144
OUTDOOR		DIMENSIONS	SQUARE FEET				
Mezzanine East Terrace		162' x 37'7" to 65'6"	18,262				
West Mezzanine West Terrace		162'8" x 38'2" to 65'6"	18,777				

General Information

Lighting

LED lighting - levels controllable at wall panel

**Note: color temperature of LED lighting is 5K*

Rooms 14-17

Glass windows and doors open to terrace. Sheers and black-out-drapes allow for enhanced A/V presentations

Airwalls

Sound absorptive panels; denoted by dotted lines

Access to Mezzanine Level

Mezzanine Level is accessible in three ways:

- from Cityside Ground Level Lobby West to Upper Level, across Upper Level, then down to Mezzanine Level via elevator, escalator or stairs
- from Bayside Exterior Ground Level via exterior elevator or stairs
- from Ground Level Bayside Lobby, for Exhibit Halls B & C licensees, via interior elevator, escalator or stairs



UPPER LEVEL SPECIFICATIONS

ROOM	DIMENSIONS	SQUARE FEET	CEILING HEIGHT	SEATING CAPACITIES			
				THEATER	CLASSROOM	BANQUET	RECEPTION
1AB	77'5" x 58'8"	4,515	14'6"	504	288	180	647
• 1A	37'10" x 58'8"	2,207	14'6"	220	120	90	319
• 1B	39'7" x 58'8"	2,308	14'6"	220	120	110	328
2	59'6" x 59'5"	3,509	14'6"	340	156	160	500
3	48'9" x 59'4"	2,833	14'6"	280	155	90	403
4	48'3" x 58'7"	2,839	14'6"	280	155	110	403
5AB	80'2" x 58'5"	4,667	14'6"	504	288	180	657
• 5A	39'5" x 59'5"	2,300	14'6"	220	120	90	328
• 5B	40'9" x 59'8"	2,367	14'6"	220	120	90	329
Ballroom 6ABCDEF	114'3" x 348'10"	40,781	23'8.5"	4,000	2,360	2,080	5,760
• 6A	89'11" x 114'3"	10,573	23'8.5"	1,040	576	480	1,472
• 6B	89'9" x 114'3"	10,607	23'8.5"	1,040	576	480	1,508
• 6C	59'9" x 89'10"	5,291	23'8.5"	560	360	240	754
• 6D	59'0" x 74'11"	4,508	23'8.5"	442	264	160	632
• 6E	59'0" x 74'4"	4,508	23'8.5"	442	264	160	632
• 6F	59'9" x 89'10"	5,294	23'8.5"	560	360	240	754
7AB	72'11" x 58'7"	4,254	14'6"	480	279	150	613
• 7A	33'5" x 58'7"	1,950	14'6"	200	110	80	285
• 7B	39'6" x 58'7"	2,304	14'6"	230	130	110	328
8	59'4" x 59'5"	3,498	14'6"	340	156	160	500
9	48'3" x 58'8"	2,838	14'6"	280	155	120	403
10	48'2" x 58'8"	2,836	14'6"	280	155	120	346
11AB	79'8" x 58'7"	4,639	14'6"	504	288	180	657
• 11A	39'7" x 58'8"	2,309	14'6"	220	120	90	328
• 11B	40'1" x 58'7"	2,330	14'6"	220	120	90	329
Sails Pavilion	299' x 305'5"	90,000	Varied	8,700	6,100	4,000	8,700
Ballroom 20ABCD	151'8" x 270'4"	40,706	30'0"	4,800	2,904	1,960	5,820
• 20ABC	151'0" x 178'4"	27,000	30'0"	3,052	1,856	1,380	3,857
• 20A	151'8" x 88'4"	13,100	30'0"	1,330	860	580	1,880
• 20AB	151'8" x 133'4"	20,050	30'0"	2,214	1,352	980	2,865
• 20BCD	151'0" x 182'0"	27,606	30'0"	3,034	1,912	1,380	3,943
• 20BC	151'8" x 90'0"	13,900	30'0"	1,330	896	600	1,985
• 20CD	151'8" x 137'0"	20,656	30'0"	2,132	1,352	980	2,865
• 20D	151'8" x 92'0"	13,706	30'0"	1,400	848	680	1,960
21	35'10" x 32'0"	1,222	18'0"	84	48	40	125
22	45'4" x 40'2"	1,856	18'0"	168	80	60	185
23ABC	41'8" x 88'0"	3,954	18'0"	374	224	140	405
• 23A	28'6" x 42'8"	1,211	18'0"	112	72	40	135
• 23B	30'0" x 44'4"	1,324	18'0"	112	78	40	135
• 23C	29'8" x 46'0"	1,418	18'0"	117	78	40	135
24ABC	47'3" x 88'0"	4,446	18'0"	420	256	210	420
• 24A	29'8" x 47'2"	1,461	18'0"	126	90	60	140
• 24B	30'0" x 49'4"	1,476	18'0"	126	90	60	140
• 24C	28'6" x 51'2"	1,507	18'0"	140	96	60	140
25ABC	52'4" x 89'0"	4,886	18'0"	480	320	210	480
• 25A	28'6" x 52'4"	1,550	18'0"	143	102	60	160
• 25B	30'0" x 54'4"	1,629	18'0"	154	96	60	160
• 25C	30'6" x 56'0"	1,708	18'0"	154	108	60	160
26AB	53'6" x 58'6"	3,282	18'0"	340	187	120	340
• 26A	30'0" x 54'6"	1,632	18'0"	154	96	60	170
• 26B	28'6" x 56'3"	1,655	18'0"	156	108	60	170
27AB	35'2" x 57'9"	2,109	18'0"	182	117	60	210
• 27A	35'2" x 29'6"	1,117	18'0"	78	42	40	105
• 27B	35'2" x 28'3"	992	18'0"	97	54	40	105

UPPER LEVEL SPECIFICATIONS CONTINUED...

ROOM	DIMENSIONS	SQUARE FEET	CEILING HEIGHT	SEATING CAPACITIES			
				THEATER	CLASSROOM	BANQUET	RECEPTION
28ABCDE	55'4" x 151'8"	8,458	18'0"	850	560	330	850
• 28A	55'4" x 29'8"	1,641	18'0"	143	80	60	170
• 28B	55'4" x 30'0"	1,660	18'0"	143	80	60	170
• 28C	55'4" x 30'0"	1,660	18'0"	143	80	60	170
• 28D	55'4" x 30'0"	1,660	18'0"	143	80	60	170
• 28E	55'4" x 32'0"	1,835	18'0"	154	80	60	170
29ABCD	88'6" x 57'6"	6,976	18'0"	672	484	270	720
• 29A	31'4" x 57'6"	1,835	18'0"	168	90	60	180
• 29B	30'0" x 57'6"	1,725	18'0"	168	90	60	180
• 29C	30'0" x 57'6"	1,725	18'0"	168	90	60	180
• 29D	28'6" x 57'6"	1,691	18'0"	168	90	60	180
30ABCDE	148'0" x 57'6"	8,626	18'0"	840	638	330	875
• 30A	29'8" x 57'6"	1,760	18'0"	168	108	60	175
• 30B	30'0" x 57'6"	1,725	18'0"	168	108	60	175
• 30C	30'0" x 57'6"	1,725	18'0"	168	108	60	175
• 30D	30'0" x 57'6"	1,725	18'0"	168	108	60	175
• 30E	28'6" x 57'6"	1,691	18'0"	168	108	60	175
31ABC	88'2" x 57'6"	5,176	18'0"	520	352	210	525
• 31A	28'6" x 57'6"	1,691	18'0"	168	108	60	175
• 31B	30'0" x 57'6"	1,725	18'0"	168	108	60	175
• 31C	29'8" x 57'6"	1,760	18'0"	168	108	60	175
32AB	59'4" x 57'6"	3,521	18'0"	350	198	120	350
• 32A	29'8" x 57'6"	1,760	18'0"	168	108	60	175
• 32B	29'8" x 57'6"	1,760	18'0"	168	108	60	175
33ABC	88'4" x 57'6"	5,168	18'0"	520	352	210	525
• 33A	28'6" x 57'6"	1,686	18'0"	168	108	60	175
• 33B	30'0" x 57'6"	1,725	18'0"	168	108	60	175
• 33C	29'8" x 57'6"	1,756	18'0"	168	108	60	175

OUTDOOR	DIMENSIONS	SQUARE FEET
West Terrace	282'6" x 47'6"	19,955
Pavilion Terrace	247'6" x 47'6"	17,920
Center Terrace	208'5" x 50'6"	11,395
East Terrace	689'0" x 31'0"	20,422
Plaza Terrace	249'6" x 87'0"	11,752



General Information

SAILS PAVILION

Floor Loads 150 lbs. per sq. ft

Clearance 27 ft. to the bottom of lighting encasement

Lighting RGB dimmable LED uplights (color lights)
Note: color temperature changes based on RGB
 Non dimmable HiBay LED lights
**Note: color temperature is 5K*

Rigging Production rigging in the Sails Pavilion is exclusive to our AV Contractor
Ask your event manager for more information

BALLROOM AS EXHIBIT SPACE

Specifications Two column-free ballrooms
 • Ballroom 6 has a ceiling height of 24 ft. and Ballroom 20 has a ceiling height of 30 ft.
 • Ballroom 6 and 20 can accommodate approximately 200 – 10 ft. x 10 ft. booths

Lighting • Ballroom 6 as exhibit space – LED lighting with pre-set and dimming capabilities, controllable at wall panels
 • Ballroom 20 as exhibit space – LED lighting with dimming capabilities, controllable at wall panels
Note: color temperature of LED lighting is 5K

MEETING ROOMS

Lighting LED lighting with dimming capabilities
Note: color temperature of LED lighting is 5K

Airwalls Sound absorptive panels; denoted by dotted lines

LOBBIES AND CORRIDORS

Lighting LED lighting throughout



 VISITSANDIEGO.COM

111 W. Harbor Dr., San Diego, CA 92101 | 619.525.5000

The San Diego Convention Center Corporation exclusively manages and operates the 2.6 million square foot San Diego Convention Center. In addition, the Corporation provides convention services such as housing, registration, event and destination services.