



SAN DIEGO CONVENTION CENTER



The San Diego Convention Center offers flexible and [safe meeting space](#), excellent customer service and customized food and beverage all in a destination that provides year-round appeal. Named an IAVM Venue of Excellence, our facility, located along the beautiful waterfront setting of San Diego Bay, offers four headquarter hotels and nearly 14,000 hotel rooms within walking distance.

[SALES & EVENT MANAGERS](#)

You can expect a sales team with a service philosophy that is unmatched in excellence and professionalism. They are your first point of contact to a flawless event.

Think of our knowledgeable event managers as your personal resident experts. They'll be your liaison to our full range of building services and our in-house and preferred provider services.

[VENUE SERVICES](#)

Our award-winning customer service is directly attributable to our staff and the strong partnership we have with local labor unions.

Our building places a high priority on safety and security for attendees. Our in-house security team is extensively trained and our security providers are vetted to ensure a safe and secure meeting environment.

We were the first convention center in the nation to have uniformed greeters to welcome guests. They are still the best in the industry at assisting with directions, special needs and managing traffic flow.

[FOOD & BEVERAGE](#)

Centerplate is our exclusive food and beverage partner. From fine dining to casual fare, these culinary experts customize menus and offer extraordinary cuisine.

[HYBRID EVENTS](#)

We can help you offer successful events that feature in-person programming and virtual components, often referred to as hybrid events. With our infrastructure and our experienced in-house technology partners ON Site and Smart City, our team can simplify the process for you and assist in creating an incredible event experience.

[AUDIO VISUAL](#)

Our preferred audio visual partner is ON Site, a division of ON Services. Utilizing the latest technology, combined with a focus on exceptional service, the team provides a full spectrum of AV and production rigging services.

[TECHNOLOGY](#)

Our exclusive in-house technology provider, Smart City, keeps you and your attendees connected with internet, telephone, cable TV and event radio services. Smart City engineers have the expertise and experience to develop custom network solutions based on your specific event needs.

[FEDEX OFFICE BUSINESS CENTER](#)

A full service business center is conveniently located in our lobby making it easy to get all of your business and document needs taken care of.

[DIGITAL SIGNAGE](#)

Digital Conventions, our digital signage partner, is ready to help you enhance the experience of your event. High-definition digital signage can deliver real-time information to your attendees, integrate with your social media and stream live event content to video screens throughout our venue. This modern approach is perfect for wayfinding, advertising, announcements and more.

[SAFE MEETING PROTOCOLS](#)

Our experienced team is committed to working with you to support the well-being of your event's attendees, exhibitors, staff and business partners. For the latest information about our health and safety protocols, see sdcc.link/safe-meetings.

DOWNTOWN SAN DIEGO HOTELS



HEADQUARTER HOTELS



1 GRAND HYATT SAN DIEGO



2 MARRIOTT MARQUIS SAN DIEGO MARINA



3 HILTON SAN DIEGO BAYFRONT



HOTELS

- 1 Grand Hyatt San Diego
- 2 Marriott Marquis San Diego Marina
- 3 Hilton San Diego Bayfront
- 4 Omni San Diego Hotel
- 5 Andaz San Diego
- 6 Best Western Plus Bayside Inn
- 7 The Bristol Hotel
- 8 Carté Hotel & Suites San Diego
- 9 Comfort Inn Gaslamp Convention Center
- 10 Courtyard San Diego Downtown
- 11 Courtyard San Diego Downtown Gaslamp
- 12 DoubleTree by Hilton San Diego Downtown
- 13 Embassy Suites San Diego Bay - Downtown
- 14 Four Points by Sheraton San Diego Downtown

ROOMS

- 1,628 15 The Guild San Diego
- 1,360 16 Hampton Inn by Hilton San Diego - Downtown
- 1,190 17 Hard Rock Hotel San Diego
- 511 18 Hilton Garden Inn/Homewood Suites
- 159 19 Hilton San Diego Gaslamp Quarter
- 122 20 Holiday Inn Express San Diego Downtown
- 102 21 Horton Grand Hotel
- 239 22 Hotel Indigo San Diego Gaslamp Quarter
- 103 23 Hotel Republic
- 245 24 Hotel Z
- 90 25 InterContinental San Diego
- 333 26 Kimpton Hotel Palomar San Diego
- 337 27 Solamar San Diego
- 220 28 Moxy San Diego Gaslamp Downtown

- 163 29 The Pendry
- 177 30 Porto Vista Hotel
- 420 31 Ramada - Gaslamp/Convention Center
- 204/160 32 Residence Inn San Diego Downtown
- 283 33 Residence Inn San Diego Downtown/Gaslamp Quarter
- 148 34 San Diego Marriott Gaslamp Quarter
- 132 35 The Sofia Hotel
- 210 36 SpringHill Suites/Residence Inn Bayfront
- 258 37 TownePlace Suites by Marriott San Diego Downtown
- 96 38 The US GRANT - A Luxury Collection Hotel
- 400 39 The Westgate Hotel
- 183 40 The Westin San Diego
- 235 41 The Westin San Diego Gaslamp Quarter
- 126 42 Wyndham San Diego Bayside
- 317
- 189
- 99
- 121
- 240
- 306
- 211
- 253/147
- 98
- 270
- 223
- 436
- 450
- 600

TOTAL ROOMS

13,500+

FLOOR PLAN OVERVIEW

UPPER LEVEL

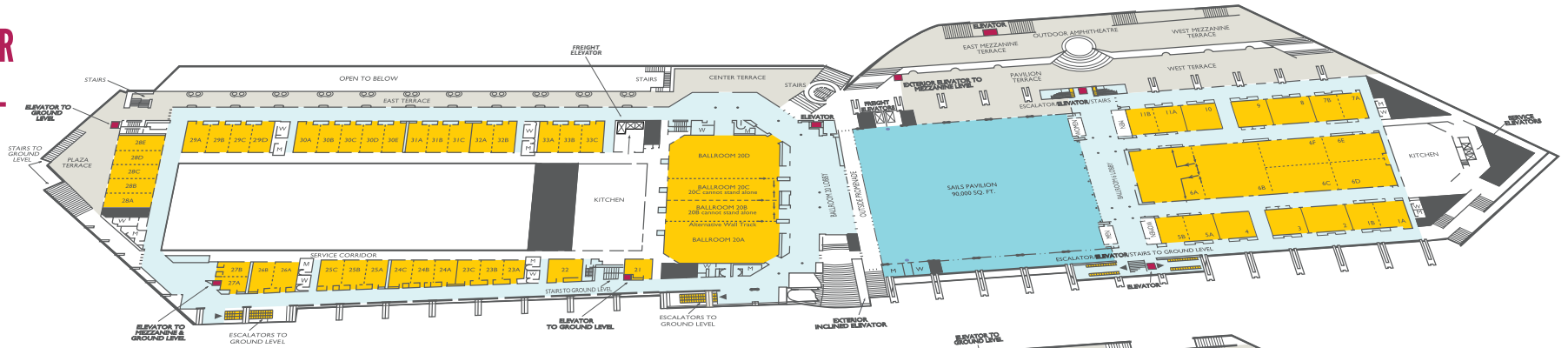

MEZZANINE LEVEL

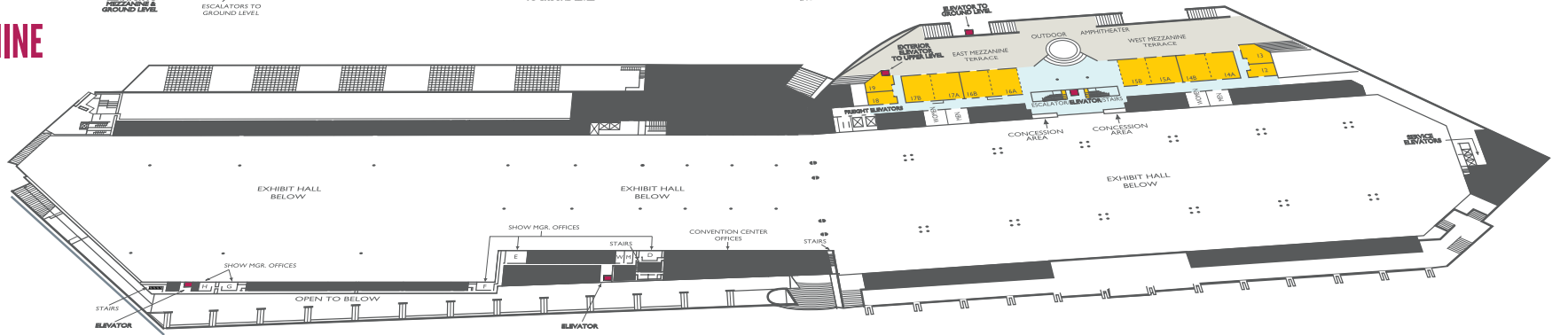

**GROUND
LEVEL**

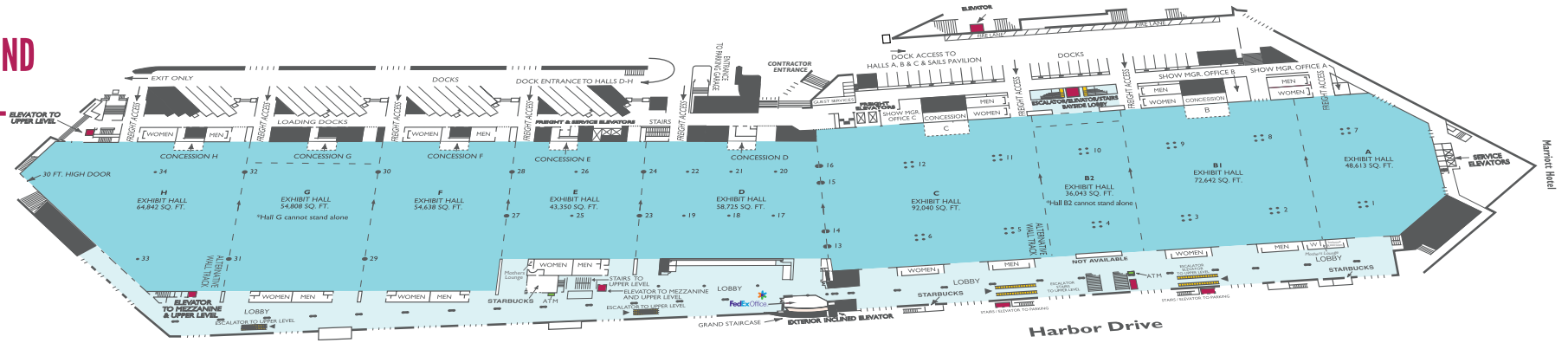

GROUND LEVEL SPECIFICATIONS

EXHIBIT HALL	DIMENSIONS	SQ. FT.	CEILING HEIGHT	SEATING CAPACITIES				10' X 10' BOOTHS
				THEATER	CLASSROOM	BANQUET	RECEPTION	
A	180'0" x 299'4"	48,613	27'4" to 40'0"	4,500	2,850	2,140	4,500	270
B 1	236'9" x 299'4"	72,642	27'4" to 40'0"	6,000	4,548	3,120	6,000	406
B 2 [†]	119'9" x 299'4"	36,043	27'4" to 40'0"	2,500	1,808	1,390	2,500	203
B1–B2	299'4" x 356'6"	108,685	27'4" to 40'0"	8,500	6,772	5,060	8,500	609
C	298'6" x 299'4"	92,040	27'4" to 40'0"	6,600	5,300	4,600	6,600	509
B2–C	299'4" x 418'3"	128,083	27'4" to 40'0"	9,100	7,288	5,880	9,100	708
A–C	838'9" x 299'4"	249,338	27'4" to 40'0"	20,000	16,936	12,640	20,000	1,388
D	256'0" x 240'4"	58,725	27'4" to 39'0"	5,880	4,244	2,690	5,880	324
E	180'0" x 240'4"	43,350	27'4" to 39'0"	4,330	3,044	2,010	4,330	240
F	180'0" x 304'0"	54,638	36'4" to 64'0"	5,750	3,840	2,480	6,000	311
G [†]	180'0" x 304'0"	54,808	36'4" to 64'0"	5,750	3,840	2,480	6,000	311
F–G	360'0" x 304'0"	109,446	36'4" to 64'0"	12,000	8,536	5,690	12,000	596
H	295'0" x 304'0"	64,842	36'4" to 64'0"	6,130	4,520	2,900	6,700	365
G–H	475'0" x 304'0"	119,650	36'4" to 64'0"	12,327	9,568	6,150	12,700	604
D–H	1,072'6" x 304'0"	276,363	varies	varies	varies	12,770	varies	1,551
A–H	1,918'0" x 304'0"	525,701	varies	varies	varies	varies	varies	2,939

[†]Halls B2 and G cannot stand alone.

MEZZANINE LEVEL SPECIFICATIONS

ROOM	DIMENSIONS	SQ. FT.	CEILING HEIGHT	SEATING CAPACITIES			
				THEATER	CLASSROOM	BANQUET	RECEPTION
12	27'10" x 38'11"	1,055	10'	84	55	40	150
13	34'1" x 36'10"	1,038	9'11.5"	75	60	40	152
14 A	37'7" x 58'5"	2,310	14'6"	230	117	90	332
14 B	39'6" x 58'6"	2,306	14'6"	230	130	90	334
14 A–B	77'1" x 58'5"	4,616	14'6"	520	296	180	665
15 A	39'6" x 58'6"	2,304	14'6"	235	130	90	334
15 B	39'8" x 58'6"	2,311	14'6"	230	130	90	332
15 A–B	79'2" x 58'6"	4,615	14'6"	546	296	180	665
16 A	39'8" x 58'7"	2,312	14'6"	230	130	90	332
16 B	39'7" x 58'7"	2,314	14'6"	230	130	90	334
16 A–B	79'3" x 58'7"	4,626	14'6"	546	296	180	665
17 A	58'6" x 39'7"	2,311	14'6"	230	130	90	332
17 B	58'6" x 39'7"	2,314	14'6"	230	130	90	332
17 A–B	79'2" x 58'6"	4,615	14'6"	546	296	180	664
18	27'8" x 38'11"	1,049	9'11.5"	84	55	40	150
19	34'8" x 36'8"	1,007	9'11.5"	72	51	40	144

BAYSIDE TERRACE	DIMENSIONS	SQ. FT.
Mezzanine Terrace	328'7" x 333'10"	38,000

UPPER LEVEL SPECIFICATIONS

ROOM	DIMENSIONS	SQ. FT.	CEILING HEIGHT	SEATING CAPACITIES			
				THEATER	CLASSROOM	BANQUET	RECEPTION
1 A	37'10" x 58'8"	2,207	14'6"	220	120	90	319
1 B	39'7" x 58'8"	2,308	14'6"	220	120	110	328
1 A–B	77'5" x 58'8"	4,515	14'6"	504	288	180	647
2	59'6" x 59'5"	3,509	14'6"	340	156	160	500
3	48'9" x 59'4"	2,833	14'6"	280	155	90	403
4	48'3" x 58'7"	2,839	14'6"	280	155	110	403
5 A	39'5" x 59'5"	2,300	14'6"	220	120	90	328
5 B	40'9" x 59'8"	2,367	14'6"	220	120	90	329
5 A–B	80'2" x 58'5"	4,667	14'6"	504	288	180	657
6 A*	89'11" x 114'3"	10,573	23'8.5"	1,040	576	480	1,472
6 B*	89'9" x 114'3"	10,607	23'8.5"	1,040	576	480	1,508
6 C*	59'9" x 89'10"	5,291	23'8.5"	560	360	240	754
6 D*	59'0" x 74'11"	4,508	23'8.5"	442	264	160	632
6 E*	59'0" x 74'4"	4,508	23'8.5"	442	264	160	632
6 F*	59'9" x 89'10"	5,294	23'8.5"	560	360	240	754
6 A–F*	114'3" x 348'10"	40,781	23'8.5"	4,000	2,360	2,080	5,760
7 A	33'5" x 58'7"	1,950	14'6"	200	110	80	285
7 B	39'6" x 58'7"	2,304	14'6"	230	130	110	328
7 A–B	72'11" x 58'7"	4,254	14'6"	480	279	150	613
8	59'4" x 59'5"	3,498	14'6"	340	156	160	500
9	48'3" x 58'8"	2,838	14'6"	280	155	120	403
10	48'2" x 58'8"	2,836	14'6"	280	155	120	346
11 A	39'7" x 58'8"	2,309	14'6"	220	120	90	328
11 B	40'1" x 58'7"	2,330	14'6"	220	120	90	329
11 A–B	79'8" x 58'7"	4,639	14'6"	504	288	180	657

*Ballroom

UPPER LEVEL SPECIFICATIONS *(Continued)*

ROOM	DIMENSIONS		SQ. FT.	CEILING HEIGHT	SEATING CAPACITIES			
					THEATER	CLASSROOM	BANQUET	RECEPTION
20 A*	151'8"	x 88'4"	13,100	30'0"	1,330	860	580	1,880
20 A-B*	151'8"	x 133'4"	20,050	30'0"	2,214	1,352	980	2,865
20 A-C*	151'0"	x 178'4"	27,000	30'0"	3,052	1,856	1,380	3,857
20 B-C*	151'8"	x 90'0"	13,900	30'0"	1,330	896	600	1,985
20 B-D*	151'0"	x 182'0"	27,606	30'0"	3,034	1,912	1,380	3,943
20 C-D*	151'8"	x 137'0"	20,656	30'0"	2,132	1,352	980	2,865
20 D*	151'8"	x 92'0"	13,706	30'0"	1,400	848	680	1,960
20 A-D*	151'8"	x 270'4"	40,706	30'0"	4,800	2,904	1,960	5,820
21	35'10"	x 32'0"	1,222	18'0"	84	48	40	125
22	45'4"	x 40'2"	1,856	18'0"	168	80	60	185
23 A	28'6"	x 42'8"	1,211	18'0"	112	72	40	135
23 B	30'0"	x 44'4"	1,324	18'0"	112	78	40	135
23 C	29'8"	x 46'0"	1,418	18'0"	117	78	40	135
23 A-C	41'8"	x 88'0"	3,954	18'0"	374	224	140	405
24 A	29'8"	x 47'2"	1,461	18'0"	126	90	60	140
24 B	30'0"	x 49'4"	1,476	18'0"	126	90	60	140
24 C	28'6"	x 51'2"	1,507	18'0"	140	96	60	140
24 A-C	47'3"	x 88'0"	4,446	18'0"	420	256	210	420
25 A	28'6"	x 52'4"	1,550	18'0"	143	102	60	160
25 B	30'0"	x 54'4"	1,629	18'0"	154	96	60	160
25 C	30'6"	x 56'0"	1,708	18'0"	154	108	60	160
25 A-C	52'4"	x 89'0"	4,886	18'0"	480	320	210	480
26 A	30'0"	x 54'6"	1,632	18'0"	154	96	60	170
26 B	28'6"	x 56'3"	1,655	18'0"	156	108	60	170
26 A-B	53'6"	x 58'6"	3,282	18'0"	340	187	120	340
27 A	35'2"	x 29'6"	1,117	18'0"	78	42	40	105
27 B	35'2"	x 28'3"	992	18'0"	97	54	40	105
27 A-B	35'2"	x 57'9"	2,109	18'0"	182	117	60	210
28 A	55'4"	x 29'8"	1,641	18'0"	143	80	60	170
28 B	55'4"	x 30'0"	1,660	18'0"	143	80	60	170
28 C	55'4"	x 30'0"	1,660	18'0"	143	80	60	170
28 D	55'4"	x 30'0"	1,660	18'0"	143	80	60	170
28 E	55'4"	x 32'0"	1,835	18'0"	154	80	60	170
28 A-E	55'4"	x 151'8"	8,458	18'0"	850	560	330	850
29 A	31'4"	x 57'6"	1,835	18'0"	168	90	60	180
29 B	30'0"	x 57'6"	1,725	18'0"	168	90	60	180
29 C	30'0"	x 57'6"	1,725	18'0"	168	90	60	180
29 D	28'6"	x 57'6"	1,691	18'0"	168	90	60	180
29 A-D	88'6"	x 57'6"	6,976	18'0"	672	484	270	720
30 A	29'8"	x 57'6"	1,760	18'0"	168	108	60	175
30 B	30'0"	x 57'6"	1,725	18'0"	168	108	60	175
30 C	30'0"	x 57'6"	1,725	18'0"	168	108	60	175
30 D	30'0"	x 57'6"	1,725	18'0"	168	108	60	175
30 E	28'6"	x 57'6"	1,691	18'0"	168	108	60	175
30 A-E	148'0"	x 57'6"	8,626	18'0"	840	638	330	875
31 A	28'6"	x 57'6"	1,691	18'0"	168	108	60	175
31 B	30'0"	x 57'6"	1,725	18'0"	168	108	60	175
31 C	29'8"	x 57'6"	1,760	18'0"	168	108	60	175
31 A-C	88'2"	x 57'6"	5,176	18'0"	520	352	210	525
32 A	29'8"	x 57'6"	1,760	18'0"	168	108	60	175
32 B	29'8"	x 57'6"	1,760	18'0"	168	108	60	175
32 A-B	59'4"	x 57'6"	3,521	18'0"	350	198	120	350
33 A	28'6"	x 57'6"	1,686	18'0"	168	108	60	175
33 B	30'0"	x 57'6"	1,725	18'0"	168	108	60	175
33 C	29'8"	x 57'6"	1,756	18'0"	168	108	60	175
33 A-C	88'4"	x 57'6"	5,168	18'0"	520	352	210	525
Sails Pavilion	299'	x 305'5"	90,000	Varied	8,700	6,100	4,000	8,700

OUTDOOR, UPPER LEVEL SPECIFICATIONS

BAYSIDE TERRACES	DIMENSIONS		SQ. FT.
Pavilion Terrace	247'6"	x 47'6"	17,920
West Terrace	282'6"	x 47'6"	19,955
Plaza Terrace	249'6"	x 87'0"	11,752
East Terrace	68'8"	x 25'0"	20,422
Center Terrace	208'5"	x 50'6"	11,395

*Ballroom

All capacities based on calculations of the San Diego Fire Marshal. Additional Exhibit Hall room configurations are available.

Please contact your San Diego Convention Center event manager for custom room set ups or more information. Visit our website at visitsandiego.com.

SAN DIEGO CONVENTION CENTER

SUSTAINABILITY & COMMUNITY

The San Diego Convention Center has been a proud industry leader in sustainability for decades. Our practices are recognized for going above and beyond when it comes to environmental responsibility at our venue. In 2018, we achieved Level Three certification to the APEX/ASTM Environmentally Sustainable Event Standards.

We also support our community through donation drives and volunteer activities



in partnership with local nonprofits serving the military, children, and unsheltered populations.

ENVIRONMENTALLY CONSCIOUS

We believe in the importance of recycling and reducing waste. 4-Stream waste receptacles are located throughout the building, allowing attendees to recycle during events. The four streams include paper, recyclables, trash and compost.

Additionally, we are environmentally-responsible with the products we purchase, including paper towels, tissues, toilet paper, cleaning products, cutlery, plates, and more. All of our in-house contractors are required to adhere to the same purchasing practices.

ENERGY EFFICIENT

Our entire facility uses LED light fixtures. Using LED lights saves on electricity and we estimate that the bulbs paid for themselves in less than two years.

COMPOSTING

We compost all non-edible food. Our kitchens do not have garbage disposals so no food scraps are wasted.

DONATIONS

When food is prepared but not served, we donate it to the San Diego Rescue Mission. One year's worth of food donations plates over 100,000 meals, on average.

Another big part of our donation program is providing convention items that can be used by local organizations. One example is partnering with Habitat for Humanity to provide materials they can use to build houses. With effective coordination, our team can ensure that meeting planners and exhibitors are able to donate excess items and materials.



111 W. Harbor Dr., San Diego, CA 92101

619.525.5000

[VISITSANDIEGO.COM](https://visitsandiego.com)